



# THE WINDMILL MOTEL & EVENTS CENTRE

CORPORATE EVENTS PACKAGE

*@windmill.motel / ph: (07) 4944 3344*

*functions@windmillmotel.com.au*

---

WWW.WINDMILLMOTEL.COM.AU

# CORPORATE EVENTS AT WINDMILL MOTEL & EVENTS CENTRE

At the Windmill Motel & Events Centre, we offer a range of tailored corporate packages ideal for events, conferences, and training seminars. With a variety of room types available, we can provide the perfect solution to meet your company's needs.

Our fully air-conditioned and versatile event venue features soundproof doors, allowing the space to be divided into three separate rooms if required. The Outback Room, our largest configuration, accommodates up to 220 guests in theatre style or 160 guests in banquet style. We also offer a variety of catering options, including breakfast, lunch, and dinner. All menus are thoughtfully created by our qualified and experienced head chef and kitchen team, prepared on-site, and can be customised to suit your event.

At the Windmill Motel & Events Centre, we pride ourselves on delivering friendly, professional service. Combined with our exceptional catering and beautiful surroundings, we are confident you'll be impressed by the high-quality events we can help you host.

*WARM REGARDS,  
THE TEAM AT WINDMILL MOTEL & EVENTS CENTRE*





# CORPORATE MEETING PACKAGES

We offer flexible and professional corporate packages to suit the needs of both full-day and half-day events. Each package includes quality catering, thoughtful room arrangements, and seamless amenities to support your event's success.

## Price Includes

- Fully air-conditioned meeting room
- Full room set-up as requested
- Mints and chilled water station
- White or black premium table linens
- Lectern
- Unlimited WIFI

## Optional Equipment & Extras

Enhance your event with the following add-ons, available upon request:

- Data Projector & Screen - \$150.00
- Microphone - \$30.00
- Whiteboard & Pens - \$15.00 each
- Flipcharts & Paper - \$30.00 each
- Speakers - \$60.00

## CONFERENCE DAY PACKAGE: MINIMUM 30 GUESTS \$65 PER GUEST

**Inclusions: Conference Room Hire | 8:00am – 5:00pm |  
Iced Water | Mints | Notepads & Pens On Arrival**

### BEVERAGES

- COFFEE, TEA & JUICE

### MORNING TEA

- FRESHLY BAKED SCONES WITH JAM & CREAM
- COFFEE & TEA

### BONUS

- 20% OFF ALL BUDDY BOY KITCHEN DINNERS ON THE NIGHT OF THE CONFERENCE

### LUNCH

- GOURMET SANDWICH SELECTION
- SEASONAL FRUIT PLATTER
- COFFEE, TEA, JUICE & SOFT DRINKS

### AFTERNOON TEA

- ASSORTED MUFFINS
- COFFEE & TEA

## ON ARRIVAL. MORNING TEA. LUNCH & AFTERNOON TEA SELECTION

### BEVERAGES

- FRESHLY BREWED TEA & COFFEE - \$5.00 PER CUP OR \$24.00 PER POT

### MORNING & AFTERNOON TEA

- SEASONAL TROPICAL FRUIT PLATTER - \$13.00 PER GUEST
- WARM CONTINENTAL COOKIES - \$9.50 PER GUEST
- ASSORTED MUFFINS - \$12.50 PER GUEST
- FRESHLY BAKED CROISSANTS WITH BUTTER & PRESERVES - \$13.50 PER GUEST
- HANDMADE SCONES WITH JAM & CREAM - \$13.50 PER GUEST
- DANISH PASTRIES - \$13.50 PER GUEST

### LUNCH SELECTIONS

- GOURMET SANDWICH & WRAP SELECTION - \$13.50 PER GUEST
- GOURMET OPEN DANISH SANDWICH PLATTER - \$15.50 PER GUEST

### SWEET & SAVOURY PLATTERS

- BOUTIQUE DESSERT PASTRIES SERVED WITH TEA & COFFEE - \$17.50 PER GUEST
- AUSTRALIAN FARMHOUSE CHEESE BOARD WITH QUINCE PASTE, DRIED FRUITS, CRISPBREADS & CRACKERS - \$19.00 PER GUEST

## REFRESHMENTS

- CANS OF SOFT DRINKS - \$4.00 EACH
- PINEAPPLE, APPLE, OR ORANGE JUICE - \$5.00 EACH
- BARISTA-MADE COFFEE - \$5.50 EACH

## BREAKFAST & DINNER

AVAILABLE DAILY AT THE BUDDY BOY KITCHEN RESTAURANT.

## BEVERAGE PACKAGES

### BASIC BEVERAGE PACKAGE (3 HOURS)

**ADDITIONAL \$49.50 PER GUEST**

#### INCLUDES

- PROSECCO (VIC)
- SAUVIGNON BLANC (SA)
- SHIRAZ BLEND (WA)
- ASSORTED BEERS
- FRUIT JUICES
- SOFT DRINKS
- MINERAL WATER

### OPTION ONE - PREMIUM BEVERAGE UPGRADE

**ADDITIONAL \$18.50 PER GUEST**

UPGRADE THE BASIC BEVERAGE PACKAGE TO INCLUDE:

- BASIC SPIRITS (BOURBON, SCOTCH WHISKY, VODKA, BUNDABERG RUM & GIN)
- PREMIUM BEERS

### OPTION TWO - CONSUMPTION PACKAGE

GUESTS PURCHASE BEVERAGES ON CONSUMPTION THROUGHOUT THE EVENT. A FINAL ACCOUNT WILL BE PROVIDED AND SETTLED AT THE CONCLUSION OF THE FUNCTION.

### OPTION THREE - BAR TAB

SET A BAR TAB LIMIT FOR YOUR EVENT AND CHOOSE WHICH BEVERAGES ARE AVAILABLE TO GUESTS.

**EXAMPLE:** A \$4,000 BAR TAB CAN BE ALLOCATED FOR THE EVENING. ONCE THE TAB LIMIT IS REACHED, BAR SERVICE WILL REVERT TO A CASH BAR.

PREPARED FRESH ON-SITE BY OUR IN-HOUSE CHEF WHILE YOU UNWIND WITH A GLASS OF WINE OR BEER FROM OUR LICENSED BAR BUDDY BOY KITCHEN. (DRINKS NOT INCLUDED.)  
BAR TABS AND DRINKS PACKAGES CAN BE ARRANGED.



CATERING  
OPTIONS

# VENUE HIRE OPTIONS & CAPACITY

Dedicated spaces for  
your corporate needs.





DIMENSIONS  
6M (L) X 12M (W) X 3M (H)



- 20 u-shape style
- 32 cabaret style
- 30 banquet style
- 40 classroom style
- 40 theatre style
- 50 cocktail style

# SOUTHERN CROSS VENUE

\$400.00

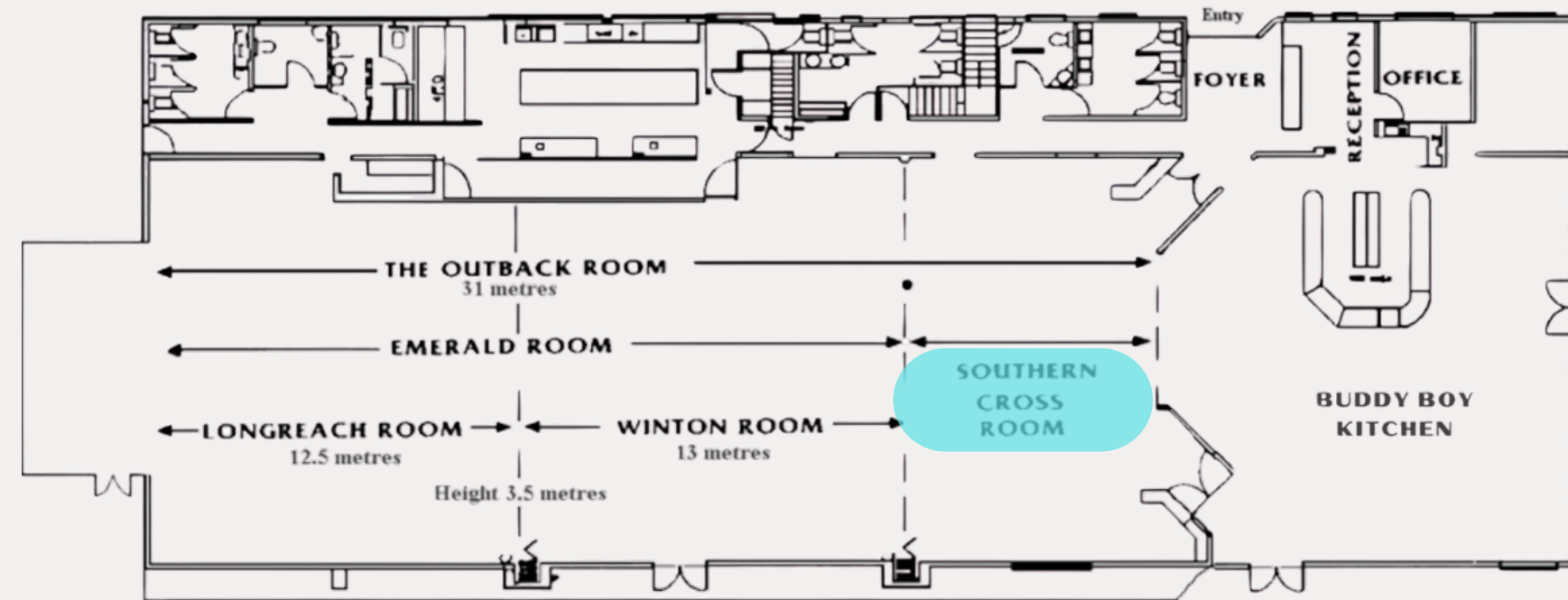



## DIMENSIONS 12M (L) X 12M (W) X 3.5M (H)



- 30 u-shape style
- 40 cabaret style
- 50 classroom style
- 60 banquet style
- 70 cocktail style
- 90 theatre style

# WINTON VENUE

# \$600.00

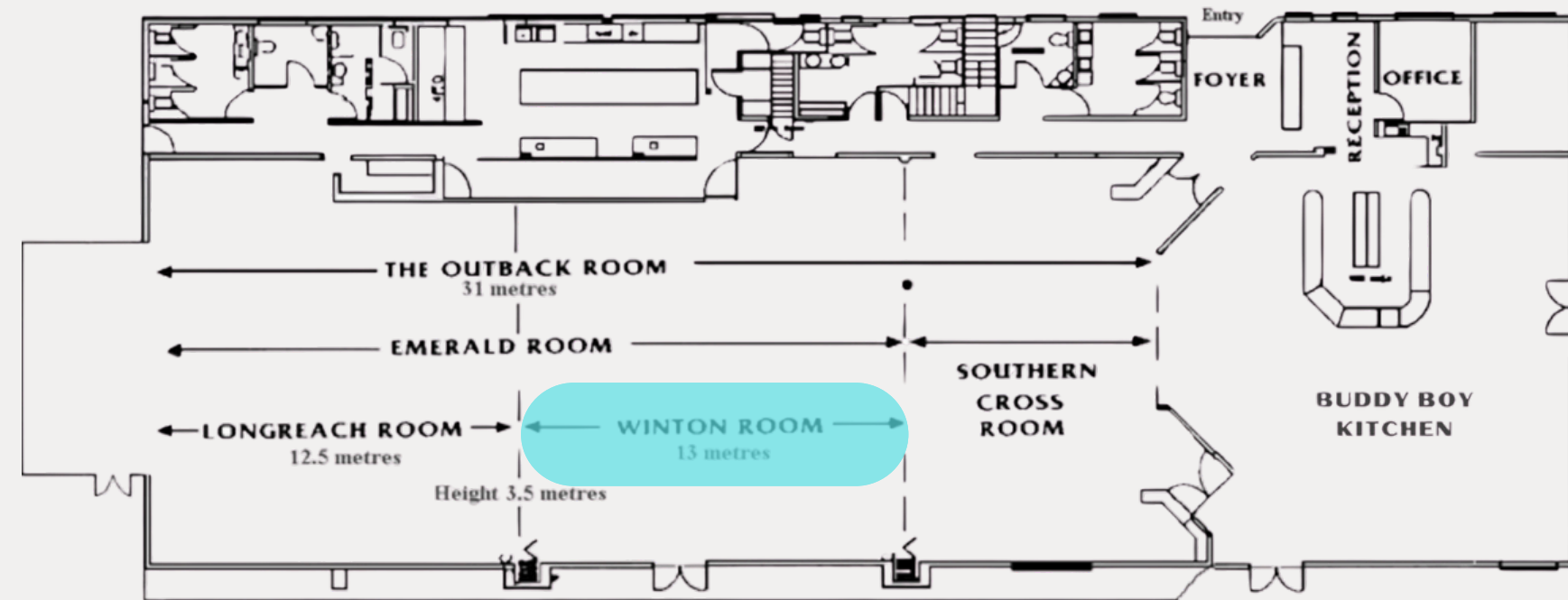



DIMENSIONS  
6M (L) X 12M (W) X 3M (H)



- 30 u-shape style
- 54 cabaret style
- 60 banquet style
- 70 classroom style
- 90 theatre style
- 90 cocktail style

# LONGREACH VENUE

\$800.00

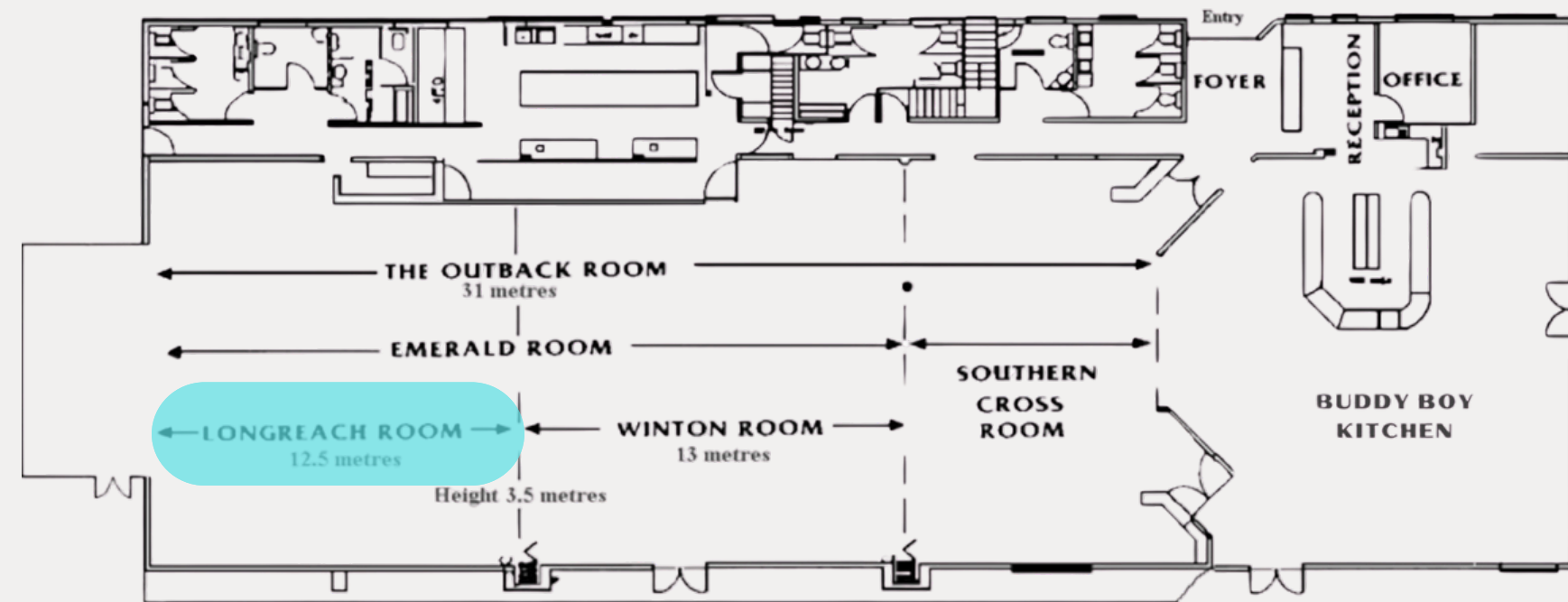



## DIMENSIONS 24M (L) X 12M (W) X 3.5M (H)

- 60 u-shape style
- 94 cabaret style
- 120 classroom style
- 130 banquet style
- 160 cocktail style
- 180 theatre style



# EMERALD VENUE

# \$1,300.00

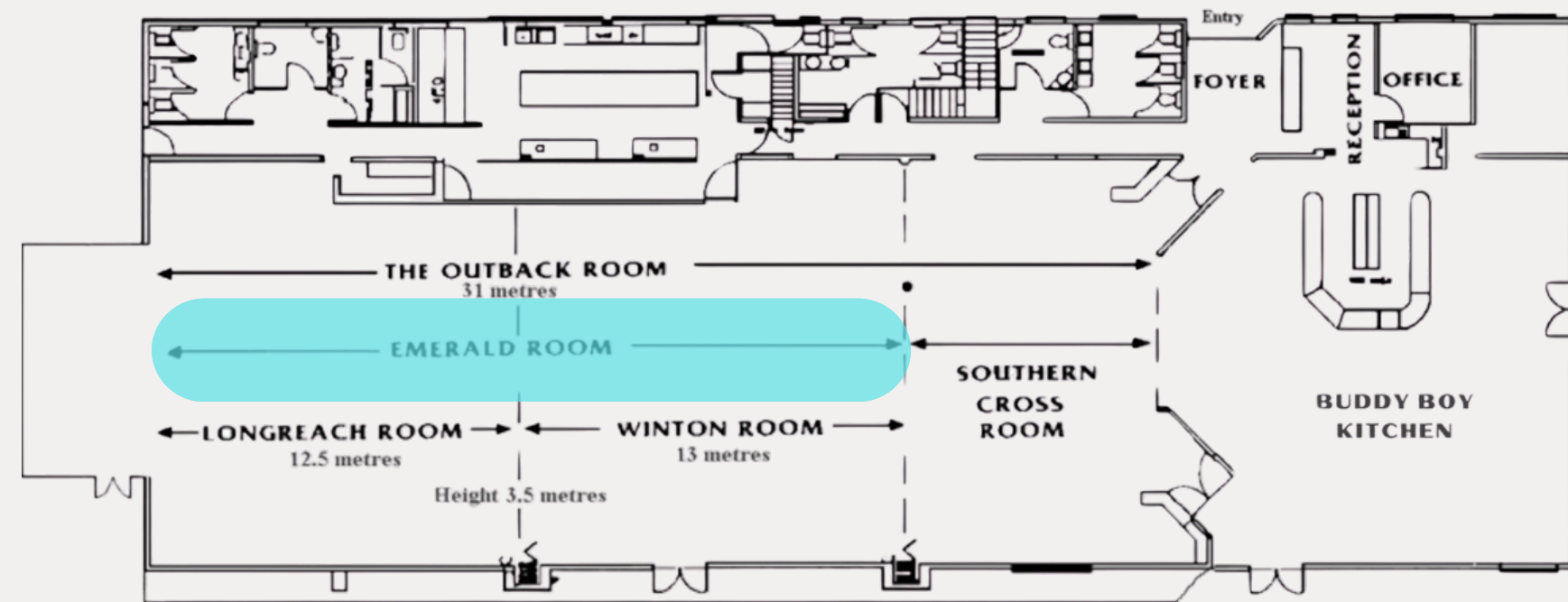



DIMENSIONS  
31M (L) X 12M (W) X 3.5M (H)



- 80 u-shape style
- 126 cabaret style
- 160 classroom style
- 160 banquet style
- 210 cocktail style
- 220 theatre style

OUTBACK  
VENUE

\$1,500.00

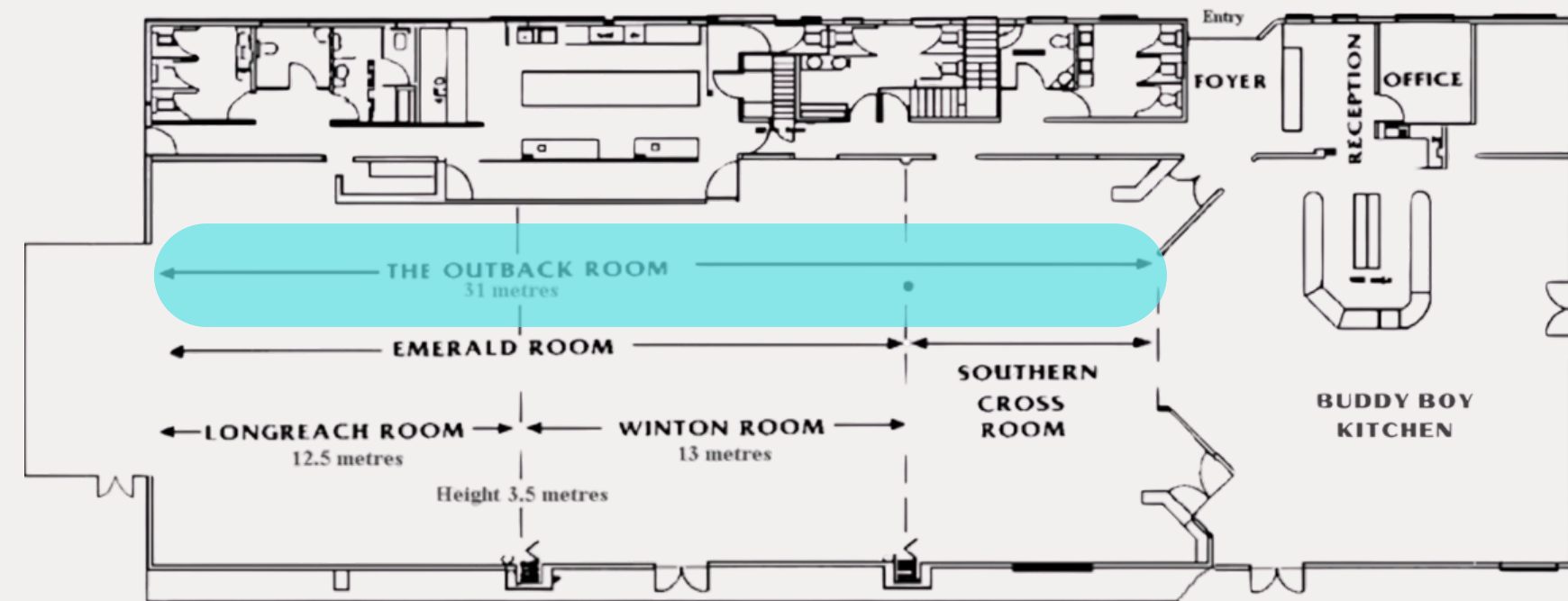



SOUTHERN CROSS  
MOTEL GROUP

# CORPORATE ACCOMMODATION OPTIONS

All corporate guests are offered a discounted rate upon request.

Please ask your attendees to call Windmill Motel and Event Centre or Southern Cross Motel Group directly, when they identify their association with your function, they can secure the discounted rate.

## QUEEN STUDIO



## SLEEPS TWO

### FEATURES

- 1x Queen Bed
- Shower Ensuite
- Tea/coffee facilities
- Bar/fridge
- Free Wi-fi

## KING STUDIO



## SLEEPS TWO

### FEATURES

- 1x King Bed
- Seating area
- Terrace/Balcony
- Corner bath & shower ensuite
- Tea/coffee facilities
- Bar fridge
- Free Wi-fi

## FAMILY STUDIO



## SLEEPS FIVE

### FEATURES

- 1x Queen Bed & 2x Single Beds OR
- 2x Queen Beds & 1 Single Bed
- Kitchenette (with microwave & toaster)
- Dining setting
- Ensuite
- Free Wi-fi

## ONE BEDROOM APARTMENT OR SUITE



## SLEEPS TWO

### FEATURES

- 1x Queen Bed (in a private bedroom)
- Kitchenette (with microwave, toaster & family-sized fridge)
- Dining setting
- Ensuite
- Free Wi-fi
- Washing machine available



# BOOKING TERMS & CONDITIONS

Terms and conditions apply to all events at the Windmill Motel & Events Centre. To finalise an event booking, please complete and return the Booking Confirmation Form.

**We look forward to hosting your next event.**

# THE WINDMILL MOTEL & EVENTS CENTRE

**GET IN TOUCH**

*functions@windmillmotel.com.au*

*www.windmillmotel.com.au*

*(07) 4944 3344*

---

WWW.WINDMILLMOTEL.COM.AU