



SOUTHERN CROSS
MOTEL GROUP

THE WINDMILL MOTEL
AND EVENTS CENTRE



CORPORATE EVENTS PACKAGE

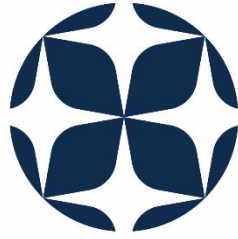

SOUTHERN CROSS
MOTEL GROUP

Corporate Package

Here at the Windmill Motel & Events Centre we offer a range of corporate package services for events, conferences and training seminars. We have several room types available and an appropriate solution whatever your company needs may be.

Our event venue is fully air-conditioned and highly versatile with soundproof doors so the space can be divided into 3 separate rooms if required. The Outback Room is our largest arrangement which can seat up to 300 guests in theatre style and 220 guests in banquet style.

Catering options including breakfast, lunch, dinner and snack services are available. All our catering menus are designed by our qualified and experienced head chef and kitchen team, are cooked on-site and can be tailored to suit your event.

We pride ourselves on delivering friendly and professional service. Together with our exceptional catering offerings and beautiful surroundings we are sure you will be delighted by the high-quality events we can help you host.

Regards,

The Team at Windmill Motel & Events Centre

Full Day Package – (8am – 6pm)

\$70pp - Minimum 15 people

Inclusions:

Fully air-conditioned meeting room
Full set-up of the room, as per request
Continuous tea & coffee station
Mints and water station
Morning and afternoon tea with 2 choices (as per offer page 7)
White or black quality table linens
Lectern
Unlimited WIFI
Light lunch with assorted handmade sandwiches, wraps & juice

Half Day Package (8am – 2pm)

\$55pp – Minimum 15 people

Inclusions:

Fully air-conditioned meeting room
Full set-up of the room, as per request
Continuous tea & coffee station
Mints and water station
Morning or afternoon tea with 2 choices (as per page 7)
White or black quality table linens
Lectern
Unlimited WIFI
Light lunch with assorted handmade sandwiches, wraps & juice

Additional extras are available

Data Projector and Screen - \$150.00

Microphone -\$30.00

Whiteboard & pens - \$15.00each

Flipcharts & paper - \$30.00 each

Speakers - \$60.00

Any extra equipment not available at Windmill Motel and Events Centre can be hired externally, this can be arranged by us at an additional cost.

Venue Options

SOUTHERN CROSS VENUE - \$350.00

(6L x 12W x 3H)

40 theatre style
30 classroom style
20 u-shape style
30 banquet style
60 cocktail styles

WINTON VENUE - \$500.00

(12L x 12W x 3.5H)

30 u-shape style
40 cabaret style
60 banquet style
100 cocktail style
70 theatre style
40 classroom style

LONGREACH VENUE - \$700.00

(12L x 12W x 3.5H)

70 theatre style
40 classroom style
30 u-shape style
40 cabaret style
60 banquet style
110 cocktail style

EMERALD VENUE - \$850.00

(24L x 12W x 3.5H)

200 theatre style
70 classroom style
60 u-shape style
80 cabaret style
140 banquet style
250 cocktail style

LAKE DECK - \$600.00

(14L x 7W x 3H)

50 banquet style
80 cocktail style

OUTBACK VENUE - \$1200.00

(310L x 12W x 3.5H)

300 theatre style
150 classroom style
110 cabaret style
220 banquet style
400 cocktail styles

Event Centre Floor Plan

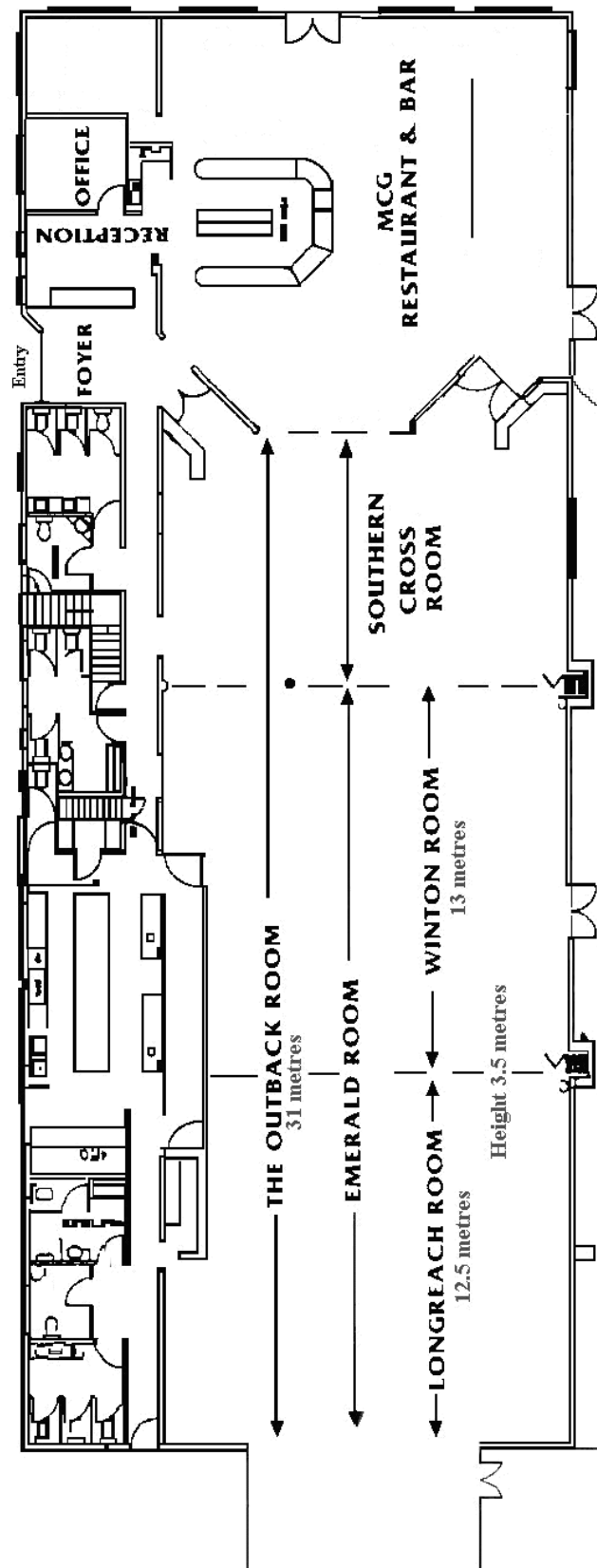

Catering Options

You will find a number of different menu options on the following pages, please be aware that pricing and menu selection within this package can be used as a guide.

Please contact us to arrange an appointment to discuss your specific event requirements so we can provide you with a personalised quote.

MORNING & AFTERNOON TEAS

(\$14 per person)

Select any 2

House Baked Sweet or Savoury Muffins
Sausage Rolls
Mini Quiches
Mini Assorted Pies
Ham and Cheese Mini Croissants
Mini Wraps with assorted fillings
Danish Pastries
Scones with Jam and Butter
House Baked Cookies
Seasonal Fresh Fruit Platter

LUNCHES

Platters of Assorted Sandwiches, Wraps & Rolls

(\$20 per person)

Hot Buffet Lunch

(Minimum 20 people - \$38 per person)

Select any 2

Roast Beef or Pork
Chicken Schnitzel
Crumbed/Battered Fish
Grilled Lamb Chops

Buffet comes with Roast Potatoes, Steamed Veges, Mediterranean Salad

REFRESHMENTS

Carafes of Fresh Orange Juice - \$18 each
Carafes of Soft Drink - \$18 each
Cans of Soft Drink - \$4 each
Barista Coffee - \$5.50 each

Fully Licensed Bar available on request POA

Corporate Accommodation Options

All corporate guests are offered a discounted rate upon request.

Please ask your attendees to call Windmill Motel and Event Centre or Southern Cross Motel Group directly, when they identify their association with your function, they can secure the discounted rate.

Windmill Motel and Event Centre Room Types:

Queen Studio	Sleeps Two	1 x Queen bed, shower ensuite, tea/coffee facilities, bar fridge, free wi-fi
King Studio	Sleeps Two	1 x King bed, seating area, terrace/balcony, combined spa tub and shower ensuite, tea/coffee facilities, bar fridge, free wi-fi
Family Studio	Sleeps Five	1 x Queen bed and 2 x Single beds Or 2 x Queen beds Pull-out sofa bed, kitchenette (with microwave and toaster), dining setting, ensuite, free wi-fi
One Bedroom Apartment or Suite	Sleeps Two	1 x Queen bed (in a private bedroom) Kitchenette (with microwave, toaster and family-sized fridge), dining setting, ensuite, free wi-fi (plus laundry in apartments)

- Porta-cots are available upon request
- Sofa-beds (suitable for 1 adult or 2 children) can be made-up upon request

Photos



Booking Terms & Conditions

Terms and conditions apply to all events at the Windmill Motel & Events Centre. To finalise an event booking, please complete and return the Booking Confirmation Form.

We look forward to hosting your next event.